

Manage Recurrent Pleural Effusions at Home

PleurX™ Pleural Catheter System



Designed with active vacuum technology to help facilitate the drainage of pleural fluid, the PleurX™ Pleural Catheter System allows your patients to manage fluid from a pleural effusion at home.

The PleurX™ Pleural Catheter System is indicated for intermittent, long term drainage of symptomatic, recurrent, pleural effusion, including malignant pleural effusions and other recurrent effusions that do not respond to medical management of the underlying disease. The device is indicated for the palliation of dyspnea due to pleural effusion and providing pleurodesis (resolution of the pleural effusion).

Patient focus

Allows patients to manage fluid in the comfort of their home, reducing the need for repeat thoracentesis procedures

Proprietary safety valve

The valve helps prevent inadvertent passage of air or fluid through the catheter. It also helps to reduce the risk of misconnection that may occur with a standard luer connection.

Fenestrations

Large, smooth fenestrations promote drainage and help reduce the risk of occlusions.

Barium stripe

Dark barium stripe provides enhanced visibility under radiography.

Vacuum bottle

Active vacuum technology drains quickly and comfortably without the need for gravity. Bottles are available in 500 mL and 1,000 mL sizes.

Roller clamp

The roller clamp provides easy control of drainage flow for optimal comfort.

Polyester cuff

This promotes tissue ingrowth to help reduce infection risk and to hold the catheter securely in place.

15.5 Fr Silicone catheter

Soft and flexible catheter conforms to the peritoneal space and helps minimize insertion-site discomfort.

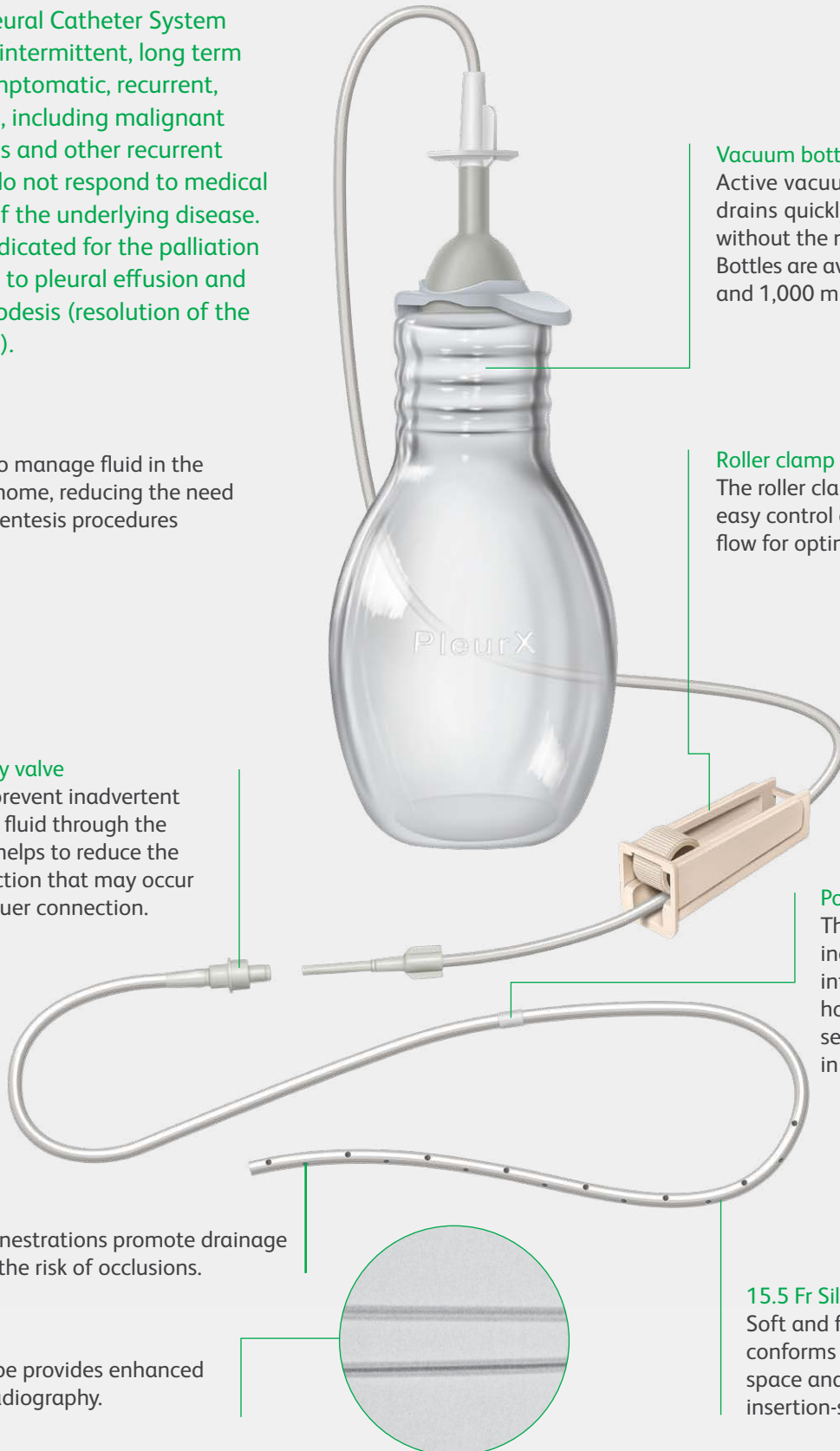

Drainage Kits

#50-7050: PleurX™ Pleural Catheter Mini Kit



50-7050 - PleurX™ Pleural Catheter Mini Kit contains:

Placement components	Drainage components	Dressing components
<ul style="list-style-type: none">• PleurX™ Pleural Catheter (15.5 Fr; 66 cm)• Guidewire introducer with needle• Syringe, 10 mL• J-tip guidewire, 60 cm• Peel-away introducer, 16 Fr; 13.7 cm dilator length; 10 cm sheath length• Tunneler• Needle foam stop	<ul style="list-style-type: none">• Lockable drainage line with access tip• Needle, 17 G x 1 in (2.5 cm)• 5-in-1 drainage line adapter• Valve cap	<ul style="list-style-type: none">• Gauze pads, 4 in x 4 in (10.2 cm x 10.2 cm, qty 6)• Foam catheter pad• Self-adhesive dressing• Lot number sticker (for traceability)

Drainage Kits

#50-7500B: PleurX™ Drainage Kit With 500ml Bottle

#50-7510: PleurX™ Drainage Kit With 1L Bottle

The PleurX™ Drainage Kits are indicated for use with the PleurX™ Catheter and PeritX™ Catheter for intermittent drainage. The drainage kit contains a procedure pack that provides the components needed – including a vacuum bottle with an attached drainage line – each time the patient drains fluid.

Procedure pack components

- Blue wrapping
- Alcohol pads (qty 3)
- Pair of gloves
- Valve cap
- Blue emergency slide clamp
- Gauze pads, 4 in x 4 in (10.2 cm x 10.2 cm, qty 4)
- Foam catheter pad
- Self-adhesive dressing

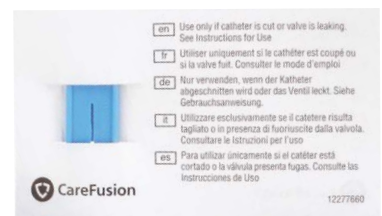

Accessories

#50-7262: PleurX™ Supplemental Insertion Kit

The PleurX™ Supplemental Insertion Kit is intended to aid in the percutaneous insertion of a PleurX™ Catheter into the pleural space and PeritX™ Catheter into the peritoneal space. The orange stylet occludes the fenestrations in the catheter, which can help to reduce the amount of fluid leakage during catheter placement. The stylet also makes the catheter more rigid for ease of insertion into the valved introducer. The valved introducer helps reduce air entering into and fluid leaking from the pleural or peritoneal space.

Insertion kit components

- Catheter insertion stylet
- Valved peel-away introducer

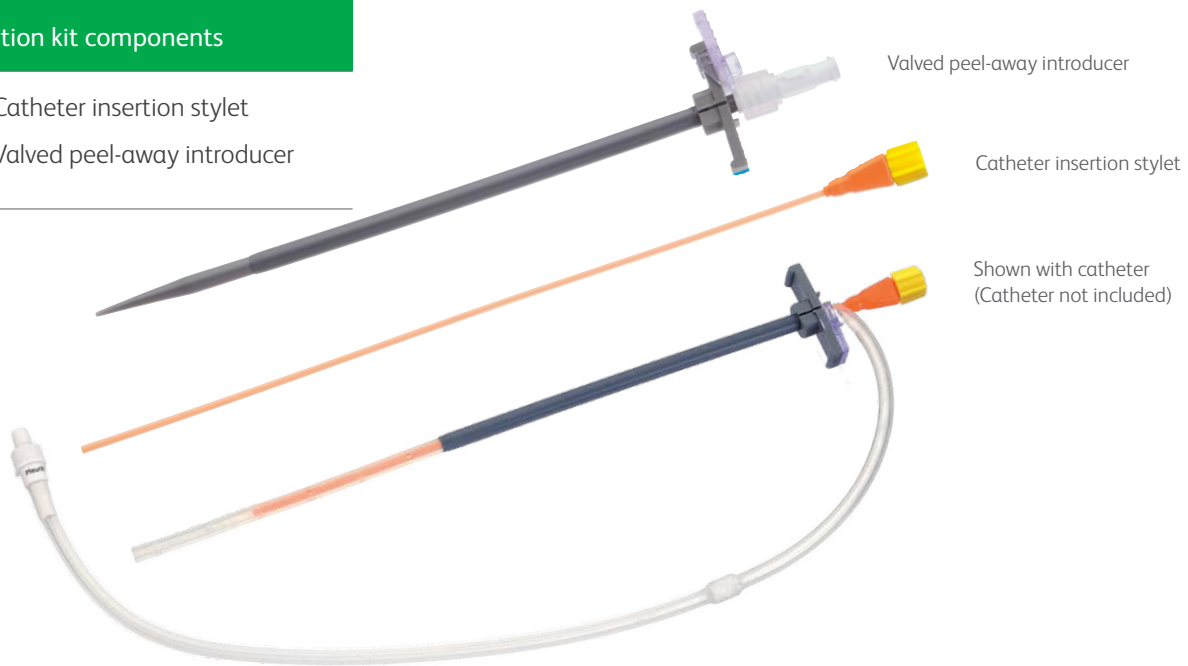

#50-7280A: Catheter Access Kit

(For use with the PleurX™ Pleural Catheter System or PeritX™ Peritoneal Catheter System)
Fluid samples can help diagnose a complex problem. The catheter access kit is designed to aspirate a sterile fluid sample directly through the catheter. The catheter access kit is also designed to allow catheter flushing and perform routine maintenance.

Catheter access kit components

- Syringe, 10 mL
- Lockable access tip with needleless access valve
- Blue wrapping
- Valve cap
- Alcohol pads (qty 2)
- Blue emergency slide clamp



Accessories

#50-7272: PeritX™ Emergency Valve Replacement Kit

The emergency valve replacement kit allows you to replace the valve if it becomes damaged.

Valve kit components

- Valve
- Valve cap
- Blue emergency slide clamp
- Scissors
- Blue wrapping
- Gauze pads, (10.2 cm x 10.2 cm, qty 4)
- Foam catheter pad
- Self-adhesive dressing



#50-7290A: Procedure Pack

(For use with the PleurX™ Pleural Catheter System or PeritX™ Peritoneal Catheter System)

The procedure pack allows patients to change dressings with a clean technique and sterile supplies even when they do not need to drain.

Valve kit components

- Blue wrapping
- Alcohol pads (qty 3)
- Pair of gloves
- Valve cap
- Blue emergency slide clamp
- Gauze pads, 4 in x 4 in (10.2 cm x 10.2 cm, qty 4)
- Foam catheter pad
- Self-adhesive dressing



Catalogue No.	Description	Quantity per case
50-7050	PleurX™ Pleural Catheter Mini Kit	1
50-7500B	PleurX™ Drainage Kit with 500 mL vacuum bottle	10
50-7510	PleurX™ Drainage Kit with 1,000 mL vacuum bottle	10
50-7235A	Replacement Valve Cap for use with the PleurX™ Catheter System or PeritX™ Catheter System	10
50-7245A	Lockable Drainage Line for use with the PleurX™ Catheter System or PeritX™ Catheter System	10
50-7262	PleurX™ Supplemental Insertion Kit	5
50-7265A	Lockable Drainage Line Kit for use with the PleurX™ Catheter System or PeritX™ Catheter System	5
50-7270	PleurX™ Emergency Valve Replacement Kit	5
50-7280A	Catheter Access Kit for use with the PleurX™ Catheter System or PeritX™ Catheter System	5
50-7290A	Procedure Pack for use with the PleurX™ Catheter System or PeritX™ Catheter System	5

PleurX™ Pleural Catheter System

Indications for Use: The PleurX™ Pleural Catheter System is indicated for intermittent, long term drainage of symptomatic, recurrent, pleural effusion, including malignant pleural effusion and other recurrent effusions that do not respond to medical management of the underlying disease. The devices are indicated for the palliation of dyspnea due to pleural effusion and providing pleurodesis (resolution of the pleural effusion). The PleurX™ Pleural Catheter is indicated for adults only.

The Lockable Drainage Line is used to drain fluid using standard wall suction, water seal drainage system, vacuum bottle, or other appropriate method.

Warnings: Do not put anything except the access tip of the Lockable Drainage Line, Catheter Access Kit, or PleurX™ Vacuum Bottles into the catheter valve since any other device could damage the valve. A damaged valve may allow air into the body or let fluid leak out through the valve when not draining.

Do not place the PleurX™ Pleural Catheter into the peritoneal space as it could lead to misidentification of the catheter and/or mistreatment of the patient.

Please consult product labels and package inserts for indications, contraindications, hazards, warnings, cautions, and information for use.

BD Switzerland Sarl

Terre Bonne Park – A4, Route De Crassier, 17, 1262 Eysins, Vaud, Switzerland
T: +41 21 556 3000

CE
0123



bd.com/drainage